

SINGER
281-30

SINGER

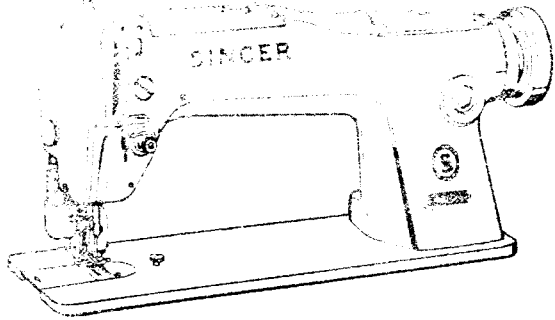

TEMPORARY PARTS LIST 281-30 ~~281-20~~ BASIC MACHINE PARTS

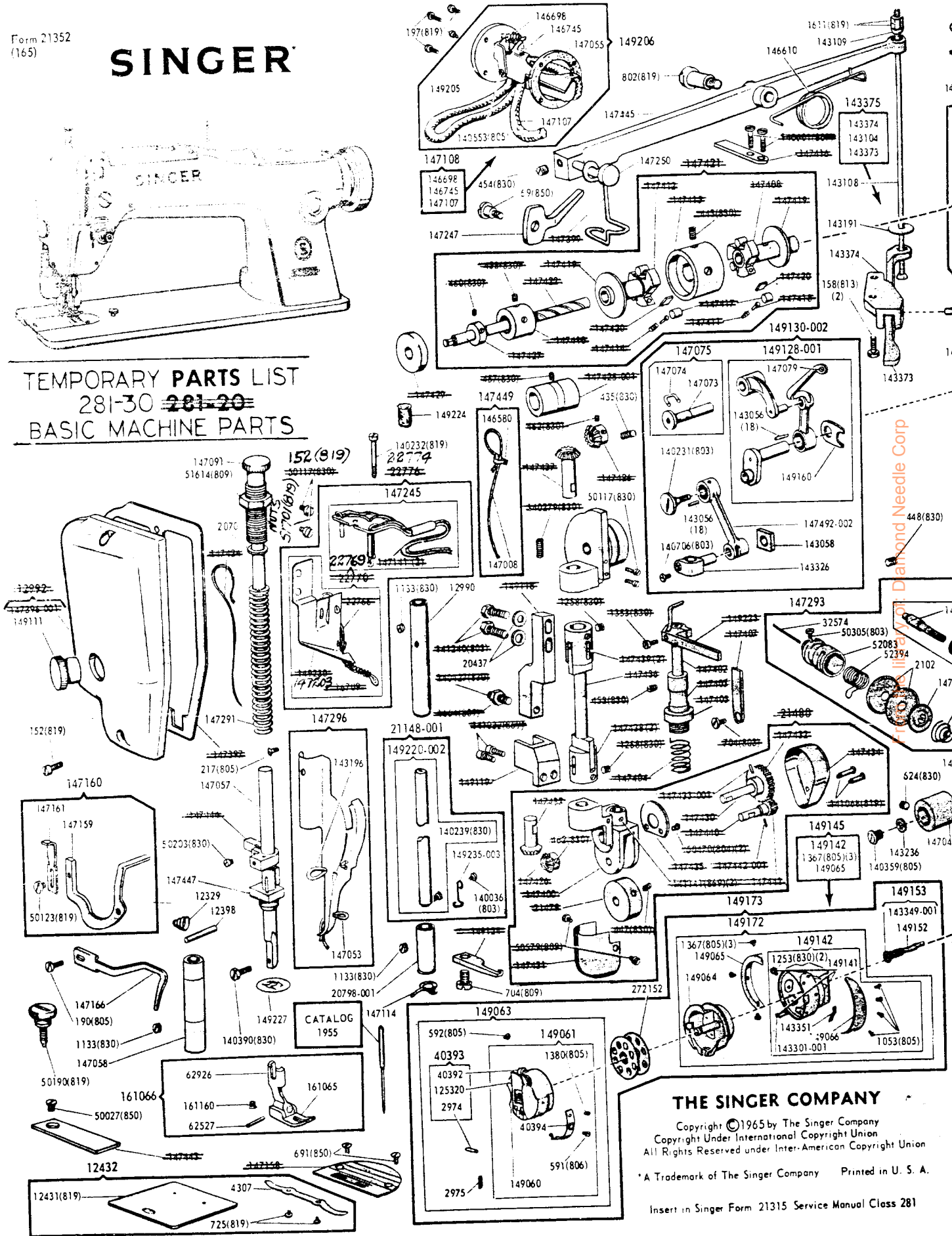

Diamond Needle Corp

THE SINGER COMPANY
 Copyright ©1965 by The Singer Company
 Copyright Under International Copyright Union
 All Rights Reserved under Inter-American Copyright Union
 *A Trademark of The Singer Company Printed in U. S. A.
 Insert in Singer Form 21315 Service Manual Class 281

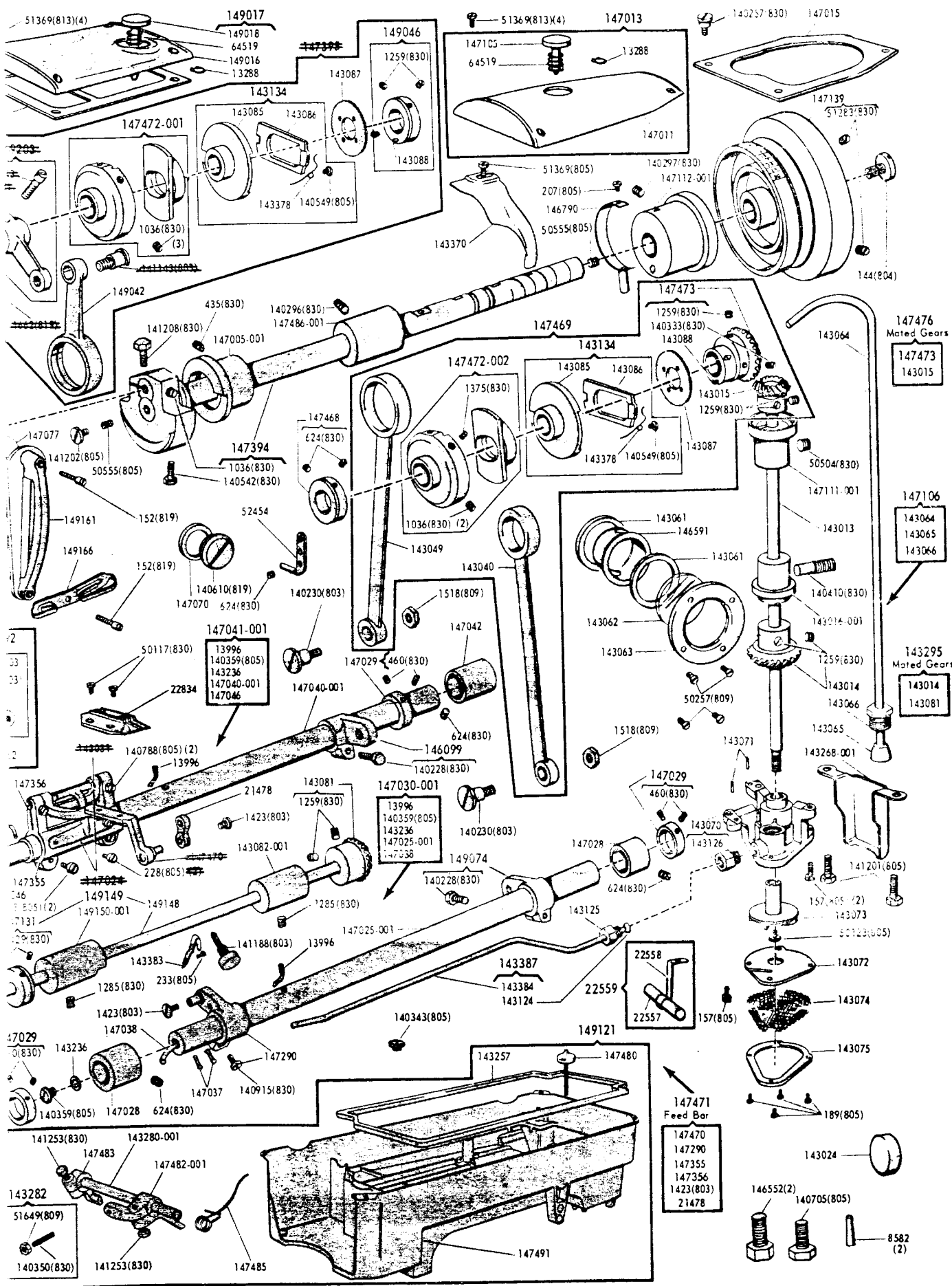

From the library of: Diamond Needle Corp

281-30
NUMERICAL LIST OF PARTS FOR ~~281-30~~ MACHINE

NUMBER	DESCRIPTION	NUMBER	DESCRIPTION	NUMBER	DESCRIPTION	NUMBER	DESCRIPTION
69(850)	Presser Bar Lifter Hinge Screw	624(830)	Arm Shaft (horizontal) Thrust Collar Set Screw(2)	12329	Tension Releasing Lever Spring	50117(8)	
144(804)	Arm Shaft (horizontal) Screw (back)	691(850)	Throat Plate Screw(2)	12398	Tension Releasing Lever Hinge Pin	50123(8)	
152(819)	Thread Take-up Lever Guard and Thread Eyelet and Thread Guard Screw (front of arm)	704(809)	Rotating Hook Bobbin Case Holder Position Bracket Screw	12431(819)	Bed Slide	50123(8)	
152(819)	Face Plate Screw(2)	704(809)	Feed Roll Bracket Shaft Guide Bracket Holder Screw	12432	Bed Slide complete, Nos. 4367, 12431(819) and two 725-819)	50190(8)	
152(819)	Thread Take-up Lever Guard Screw	725(819)	Bed Slide Spring Screw(2)	12990	Needle Bar Bushing (upper)	50203(8)	
157(805)	Oil Pump (centrifugal) Body Screw(2)	802(819)	Presser Bar and Feed Roll Lifting Lever Hinge Screw	12990	Face Plate 147296-001 with 149111	50257(8)	
157(805)	Magnet Retaining Clamp and Oil Pump (centrifugal) Body Screw	1036(830)	Thread Take-up Crank Set Screw	12997	Feed Roll (rubber covered) with 447(830)	50305(8)	
158(813)	Bell Crank Bracket Screw(2)	1036(830)	Feed Eccentric Body Set Screw(2)	13288	Note: No. 12997 is furnished on order only	50429(8)	
158(805)	Feed Bar Carrier Clamping Screw(2)	1036(830)	Feed Roll Eccentric Set Screw(3)	13288	Arm Top Cover (front) Stitch Regulator Plunger Spring Stop Ring		
189(805)	Oil Pump (centrifugal) Screen Frame Screw(4)	1053(805)	Rotating Hook Thread Guard Screw(4)	13288	Arm Top Cover (back) Stitch Regulator Plunger Stop Ring	50504(8)	
190(805)	Slack Thread Regulator Screw	1133(830)	Needle Bar Bushing (upper) Set Screw	13300	Presser Bar (adjustable) complete, Nos. 14392, 14393 and 14119(869)	50555(8)	
197(819)	Oil Removing Wick (head end) Hinge Plate and Cover Screw(4)	1133(805)	Presser Bar Bushing (lower) Set Screw		Note: No. 13300 is furnished on order only		
207(805)	Arm Shaft (horizontal) Flanged Bushing (back) Oil Sump Tube Holder Screw	1133(830)	Needle Bar Bushing (lower) Set Screw	13996	Feed Lifting Rock Shaft Oil Wick	51265(8)	
217(805)	Thread Take-up Lever Oil Guard Screw	1253(830)	Rotating Hook Set Screw(2)	13996	Feed Rock Shaft Oil Wick	51369(8)	
228(805)	Feed Bar Carrier Oil Wick Holder Screw(2)	1336(830)	Feed Roll Driving Shaft (upright) Driving Collar Set Screw(4)	14392	Presser Bar	51669(8)	
233(805)	Rotating Hook Oil Flow Regulating Thumb Screw Spring Screw	1259(830)	Arm Shaft (upright) Bevel Gear (lower) Set Screw(2)	14392	Note: No. 14392 is furnished on order only	51369(8)	
435(830)	Thread Take-up Link Hinge Stud Set Screw	1259(830)	Arm Shaft (upright) Bevel Gear (upper) Set Screw(2)	14393	Presser Foot Seat	51674(8)	
435(830)	Arm Shaft (horizontal) Flanged Bushing (front) Set Screw	1259(830)	Feed Roll Feed Regulator Locking Slide Ratchet Wheel Retaining Collar Set Screw(2)	16709	Note: No. 14393 furnished on order only	51649(8)	
443(830)	Feed Roll Clutch Body Set Screw(2)	1259(830)	Feed Lifting Eccentric Set Screw	20437	Arm Side Shield Wick Spring Holder		
447(830)	Feed Roll Set Screw	1259(830)	Rotating Hook Shaft Bevel Gear Set Screw(2)	20437	Feed Roll Guide Bar Screw Washer(2)	52083(8)	
448(830)	Thread Take-up Spring Regulator Set Screw	1285(830)	Rotating Hook Shaft Bushing (back) Set Screw	20798-001	Needle Bar Bushing (lower)	52394(8)	
453(830)	Feed Roll Bracket Shaft Bushing Set Screw	1285(830)	Rotating Hook Shaft Bushing (front) Set Screw	21148-001	Needle Bar (hollow) complete, Nos. 140036(803), 149220-002 and 149235-003	52454(8)	
453(830)	Feed Roll Clutch (bracket) Bushing Set Screw(2)	1336(830)	Feed Roll Bracket Shaft Guide Bracket Clamping Screw	21478	Feed Bar Connecting Link	62527(8)	
454(830)	Presser Bar and Feed Roll Lifting Lever Pin Set Screw	1367(805)	Rotating Hook Section Screw(3)	21478	Feed Roll (25 Pitch Diamond Knurl) with 447(830)	62926(8)	
454(830)	Feed Roll Clutch Shaft Arm Bushing (rear) Set Screw	1375(830)	Feed Eccentric Body Position Screw	21478	Note: No. 21479 is furnished as regular to machine	64519(8)	
460(830)	Feed Roll Clutch Shaft Collar Set Screw(2)	1380(805)	Rotating Hook Bobbin Case Tension Spring Screw	21478	Feed Roll Bracket complete, Nos. 21479, 147400, 147426, 147430, 147431, 147432, 147433-001, 147434, 147435, 147437, 147440, 147441, 147442-001 and two each 50470(804) 50579(809) and 141068(819)	140036(8)	
460(830)	Feed Rock Shaft Collar Set Screw(2)	1423(803)	Feed Bar Connecting Link Cap Screw(2)	22557	Magnet (for removing iron particles from oil)	140228(8)	
460(830)	Feed Lifting Rock Shaft Collar Set Screw(4)	1518(809)	Feed Lifting Rock Shaft Connecting Rod Hinge Screw Nut	22557	Magnet Retaining Clamp	140230(8)	
460(830)	Feed Roll Driving Shaft (horizontal) Bevel Gear Set Screw(2)	1518(809)	Feed Rock Shaft Connecting Rod Hinge Screw Nut	22558	Magnet Retaining Clamp	14023(8)	
462(830)	Feed Roll Clutch Shaft Bevel Gear Set Screw(2)	1560(803)	Tension Regulating Thumb Nut	22559	Magnet Retaining Clamp 22558 with 22557	14023(8)	
591(806)	Rotating Hook Bobbin Case Tension Regulating Screw	1560(803)	Tension Regulating Thumb Nut Lock Nut	22766	Arm Side Shield Wick (16 in. long)	14025(8)	
592(805)	Rotating Hook Bobbin Case Latch Stop Screw	1611(819)	Presser Bar and Feed Roll Lifting Lever Connecting Rod Nut	22766	Arm Side Shield complete, Nos. 16709, 22766 and 149230	14025(8)	
624(830)	Thread Retainer Set Screw	1611(819)	Presser Bar and Feed Roll Lifting Lever Connecting Rod Nut Lock Nut	22834	Arm Side Shield and Oil Wick Holder, Nos. 22770 and 147245	14025(8)	
624(830)	Feed Rock Shaft Bushing (back) Set Screw	1663(819)	Feed Roll Eccentric Connecting Rod Hinge Screw Nut	22837	Feed Dog (20 teeth to the inch), for use with 147158 and 161066	14025(8)	
624(830)	Feed Lifting Rock Shaft Bushing (back) Set Screw	1663(819)	Feed Roll Guide Bar Adjusting Screw Nut	32574	Feed Roll (32 rows of spiked teeth, 4 teeth to a row) with 447(830)	14025(8)	
624(830)	Feed Rock Shaft Bushing (front) Set Screw	2070	Presser Bar Spring Washer	40392	Note: No. 22837 is furnished on order only	14033(8)	
624(830)	Feed Lifting Rock Shaft Bushing (front) Set Screw	2102	Tension Disc(2)	40392	Tension Releasing Pin	14034(8)	
624(830)	Feed Lifting Rock Shaft Bushing (front) Set Screw	2974	Rotating Hook Bobbin Case Latch Lever Fulcrum Pin	40393	Rotating Hook Bobbin Case Latch	14035(8)	
		2975	Rotating Hook Bobbin Case Latch Spring	40394	Rotating Hook Bobbin Case Latch Hinge Nos. 2974, 40392 and 125320	14035(8)	
		4307	Bed Slide Spring	50027(850)	Rotating Hook Bobbin Case Tension Spring	14035(8)	
		8582	Arm Dowel Pin(2)	50027(850)	Feed Roll Plate Screw	14035(8)	
					Arm Side Shield Screw(2)		

From the library of: Diamond Needle Corp

281-30
Numerical List of Parts for 281-28 Machine

DESCRIPTION	NUMBER	DESCRIPTION	NUMBER	DESCRIPTION
Bed Dog Screw(2)	140390(830)	Presser Foot Screw	143015	Arm Shaft (upright)
Feed Pump (centrifugal)	140410(830)	Arm Shaft (upright)		Bevel Gear (upper)
Needle Locking Screw		Arm Shaft (upright)		left hand spiral with
Position Releasing Lever		Bushing (lower) Set		two 1259(830)
Adjustable Screw	140427(830)	Feed Roll Guide Bar		Note: To ensure proper
Slide Thumb Screw		Adjusting Screw		functioning of Gears
Presser Bar Guide	140542(830)	Needle Bar Crank		No. 143015 will not
Needle Clamping Screw		Position Screw		be supplied
Oil Flow Window Cap	140549(805)	Stitch Regulator		separately to Agencies,
Oil Flow Window Cap		Locking Slide Spring		but will be
Oil Flow Window Cap		Screw		substituted by Pair
Oil Flow Window Cap				of Gears No. 147476
Position Stud Set Screw	140549(805)	Feed Roll Feed	143016-001	Arm Shaft (upright)
Rotating Hook Shaft Oil		Regulator Locking		Bushing (lower)
Flange Set Screw(2)		Slide Spring Screw		Bed Hole Plug
Feed Roll Clutch Shaft	140553(805)	Oil Removing Wick	143024	Feed Bar Carrier Oil
Driving Crank Clamping		(head end) Holder		Wick
Screw		Body Hinge Screw	143040	Feed Lifting Rock
Feed Roll Driving Shaft	140601(805)	Feed Roll Clutch		Shaft Connecting Rod
(horizontal) Spur Gear		Position Bracket	143049	Feed Rock Shaft
Feed Roll Shaft		Screw(2)		Connecting Rod
Spur Gear Cover Plate	140607(819)	Arm Top Cover (back)	143056	Needle Bar Connecting
Clamping Screw(2)		Stitch Regulator		Link Roller Bearing(18)
Arm Shaft (upright)		Plunger Hole Plug Screw	143056	Thread Take-up Lever
Bushing (upper) Set		(for plugging the Plunger		Roller Bearing(18)
Screw		Hole when the Plunger	143058	Needle Bar Connecting
Arm Shaft (horizontal)		is removed to prevent		Stud Slide Block
Plug Screw(2)		tampering with the	143061	Oil Flow Body
Feed Roll Driving Shaft	140607(819)	Stitch Set)		Gasket(2)
(horizontal) Bevel Gear		Arm Top Cover (front)	143062	Oil Flow Window
Clamping Screw(2)		Stitch Regulator	143063	Oil Flow Window Cap
Machine Pulley Set		Plunger Hole Plug	143064	Oil Pipe
Screw(2)		Screw (for plugging the	143065	Oil Pipe Clamping
Arm Top Cover (front)		Plunger Hole when the		Sleeve
Screw(4)		Plunger is removed to	143066	Oil Pipe Clamping
Oil Lead Screw		prevent tampering with		Sleeve Nut
Arm Top Cover (back)		the Stitch Set)	143070	Oil Pump (centrifugal)
Screw(4)		Arm Oil Plug Screw		Body with 143126
Pressure Regulating	140610(819)	Thread Take-up Crank	143071	Oil Pump (centrifugal)
Thumb Screw Lock Nut		Clamping Screw Hole		Body Position Pin(2)
Knee Lifter Rock Shaft	140705(805)	Plug Screw	143072	Oil Pump (centrifugal)
Clamp Adjusting Screw	140706(803)	Arm Screw (back)		Cover
Lock Nut		Needle Bar Connecting	143073	Oil Pump (centrifugal)
Thread Take-up Spring		Stud Clamping Screw		Impeller
Regulator with	140788(805)	Feed Bar Hinge Pin	143074	Oil Pump (centrifugal)
1205(803)		Clamping Screw(2)		Screen
Thread Take-up Spring	140873(803)	Tension Stud		Oil Pump (centrifugal)
Thread Retainer		Feed Lifting Rock	143075	Screen Frame
Presser Foot Hinge Pin	140915(830)	Shaft Crank (front)		Rotating Hook Shaft
Presser Foot Shank		Clamping Screw	143081	Bevel Gear (left hand
Arm Top Cover (front)		Feed Roll Guide		spiral) with two
Stitch Regulator	141030(805)	Bracket Screw(2)		1259(830)
Plunger Spring		Feed Roll Driving Shaft		Note: To ensure proper
Arm Top Cover (back)	141068(819)	(horizontal) Spur Gear		functioning of Gears
Stitch Regulator		and Feed Roll Shaft		No. 143081 will not be
Plunger Spring		Spur Gear Cover		supplied separately to
Rotating Hook Bobbin	141143(805)	Screw(2)		Agencies but will be
Case Latch Lever		Feed Roll Bracket		substituted by Pair
Needle Bar Thread	141143(805)	Shaft Set Screw(2)		of Gears No. 143295
Guard Screw		Feed Roll Eccentric		Rotating Hook Shaft
Feed Lifting Rock	141143(805)	Connecting Rod	143082-001	Bushing (back)
Shaft Crank (back)		Hinge Screw		
Clamping Screw	141188(803)	Rotating Hook Oil	143085	Feed Roll Feed
Feed Rock Shaft		Flow Regulating		Regulator
Crank Clamping Screw		Thumb Screw	143085	Stitch Regulator
Feed Lifting Rock	141190(869)	Presser Foot Seat		Feed Roll Feed
Shaft Connecting Rod		Adjusting Screw	143086	Regulator Locking
Hinge Screw		Note, No. 141190(869)		Slide
Feed Rock Shaft		is furnished on	143086	Stitch Regulator
Connecting Rod Hinge		order only		Locking Slide
Screw	141201(805)	Arm and Bed Leg	143087	Regulator Locking
Needle Bar Connecting		(back) Screw(2)		Slide Ratchet Wheel
Link Cap Screw	141202(805)	Arm Shaft (horizontal)		Stitch Regulator
Oil Wick Holder Screw		Screw Plug (front)	143087	Locking Slide Ratchet
Needle Set Screw				Wheel
Feed Eccentric Stop	141208(830)	Thread Take-up Crank	143088	Feed Roll Feed
Screw (7 stitch)		Clamping Screw		Regulator Locking
Feed Eccentric Stop	141208(830)	Feed Roll Guide		Slide Ratchet Wheel
Screw (5-1/2 stitch)		Bar Screw(2)		Pin
Feed Roll Clutch			143088	Stitch Regulator Locking
Shaft Arm Bushing				Slide Ratchet Wheel Pin
(front) Set Screw			143104	Bell Crank Hinge Pin
Arm Shaft (horizontal)			143108	Presser Bar and Feed
Bushing (center)				Roll Lifting Lever
Set Screw	141253(830)	Knee Lifter Rock	143109	Connecting Rod
Arm Shaft (horizontal)		Shaft Crank Clamping		Presser Bar and Feed
Flanged Bushing		Screw		Roll Lifting Lever
(back) Set Screw	141253(830)	Knee Lifter Rock	143124	Connecting Rod Swivel
Feed Lifting Eccentric		Shaft Stop Dog		Oil Pipe Clamping
Position Screw		Clamping Screw	143125	Sleeve
Machine and Machine	143013	Arm Shaft (upright)		Oil Pipe Clamping
Base Oil Reservoir	143014	Arm Shaft (upright)	143126	Sleeve Nut
Screw Hole Plug		Bevel Gear (lower)		Oil Pipe Clamping
Screw		right hand spiral with	143134	Sleeve Nut Adaptor
		two 1259(830)		Feed Roll Feed
Knee Lifter Rock		Note: To ensure proper		Regulator 143085 with
Shaft Crank Adjusting		functioning of Gears		140549(805), 143086
Screw		No. 143014 will not be		and 143378
Feed Rock Shaft Oil		supplied separately to		
Screw Plug		Agencies, but will be		
Feed Lifting Rock		substituted by Pair of		
Shaft Oil Screw Plug		Gears No. 143295		

DESCRIPTION	NUMBER	DESCRIPTION	NUMBER	DESCRIPTION
Feed Roll Clutch (drive) Member Spring(3)	147472-002	Feed Eccentric	149145	Rotating Hook (Air Cooled) 149142 with 149065 and three 1367(805)
Feed Roll Clutch Body with two 443(830)	147473	Feed Lifting Eccentric and Arm Shaft (horizontal) Bevel Gear, right hand spiral with 1259(830), 140333(830) and 143088	149148	Rotating Hook Shaft with 149153
Feed Roll Clutch Position Bracket		Note: To ensure proper functioning of Gears, No. 147473 will not be supplied separately to Agencies, but will be substituted by Pair of Gears No. 147476	149149	Rotating Hook Shaft 149148 with 147131
Feed Roll Clutch Rolled(6)			149150-001	Rotating Hook Shaft Bushing (front)
Feed Roll Clutch Roller Plunger(6)			149152	Rotating Hook Shaft Oil Filter Wick
Feed Roll Clutch Washer(2)			149153	Rotating Hook Shaft Oil Filter complete, Nos. 143349-001 and 147152
Feed Roll Clutch Wearing Plate(6)	147476	Pair of Gears for Upper Shaft Nos. 143015 and 145473	149160	Thread Take-up Crank Wearing Plate
Feed Roll Clutch and Shaft complete, Nos. 147408, 147410, 147412, 147415, 147422, 147427 two 147419, three each 147411, 147414 and six each 147417, 147418 and 147420	147480	Knee Lifter Bell Crank Plunger	149161	Thread Take-up Lever Guard
Feed Roll Clutch Shaft	147482-001	Knee Lifter Rock Shaft Crank with 141253(830) and 143282	149166	Thread Eyelet and Thread Guard (front of arm)
Feed Roll Clutch Shaft Arm Bushing (front)	147485	Knee Lifter Rock Shaft Stop Dog with 141253(830)	149172	Rotating Hook (Air Cooled) 149142 with 149064, 149065 and three 1367(805)
Oil Wick with 146580	147485	Knee Lifter Rock Shaft Spring	149173	Rotating Hook (Air Cooled) 149172 with 149063 and 149153
Feed Roll Clutch Shaft Arm Bushing (rear)	147486-001	Arm Shaft (horizontal) Bushing (center)		
Feed Roll Clutch Shaft Bevel Gear with two 462(830)	147491	Machine Base and Oil Reservoir		
Feed Roll Driving Shaft (horizontal) Bevel Gear with two 462(830)	147492-002	Needle Bar Connecting Link	149203	Feed Roll Clutch Shaft Driving Crank with 50443(830)
Feed Roll Clutch Shaft Collar with two 460(830)	149016	Arm Top Cover (front)	149205	Oil Removing Wick (head end) Hinge Plate and Cover
Feed Roll Clutch Shaft Oil Retainer (felt)	149017	Arm Top Cover (front) with Stitch Regulator Plunger complete, Nos. 13288, 64519, 149016 and 149018	149206	Oil Removing Wick (head end) Holder Body complete, Nos. 140553(805), 146698, 146745, 147055, 147107 and 149205
Feed Roll Driving Shaft (horizontal)	149018	Arm Top Cover (front) Stitch Regulator Plunger	149220-002	Needle Bar (hollow) with 140239(830)
Feed Roll Driving Shaft (horizontal) Bevel Gear Cover	149042	Feed Roll Eccentric Connecting Rod	149222	Feed Roll Bracket Shaft Guide Bracket with 1353(830)
Feed Roll Driving Shaft (horizontal) Spur Gear	149046	Feed Roll Feed Regulator Lacking Slide Ratchet Wheel Retaining Collar with 143088 and two 1259(830)	149224	Oil Wick Holder Plug (felt)
Feed Roll Driving Shaft (horizontal) Spur Gear Pin (1/2 in. long)	149060	Rotating Hook Bobbin Case	149227	Presser Bar Bushing (lower) Washer
Feed Roll Driving Shaft (horizontal) Spur Gear and Feed Roll Shaft Spur Gear Cover	149061	Rotating Hook Bobbin Case 149060 with 591(806), 1380(805) and 40394	149230	Arm Side Shield
Feed Roll Driving Shaft (horizontal) Spur Gear and Feed Roll Shaft Spur Gear Cover Plate	149063	Rotating Hook Bobbin Case complete, Nos. 592(805), 2974, 2975, 40392, 125320 and 149061	149235-003	Needle Bar Thread Guard
Feed Roll Driving Shaft (upright)	149064	Rotating Hook Bobbin Case Holder	161065	Presser Foot Plate
Feed Roll Driving Shaft (upright) Bevel Gear (upper) and (lower)	149065	Rotating Hook Section	161066	Presser Foot (spring hinged) complete, Nos. 62527, 62926, 161065 and 161160, for use with 22834 and 147158
Feed Roll Driving Shaft (upright) Driving Collar with two 1258(830)(2)	149066	Rotating Hook Thread Guard	161160	Presser Foot Spring
Feed Roll Driving Shaft (upright) Hinge Pin (3/4 in. long)(2)	149074	Feed Lifting Rock Shaft Crank (back) with 140228(830)	272152	Rotating Hook Bobbin Needle Cat. No. 1955 (Size No. 16)
Feed Roll Shaft	149111	Face Plate Plug (for plugging the Presser Bar adjustment hole)	---	
Feed Roll Shaft Spur Gear	149112	Feed Roll Guide Bar		
Feed Roll Shaft Spur Gear Pin (3/8 in. long)	149113	Feed Roll Guide Bracket		
Feed Roll Plate	149121	Machine Base and Oil Reservoir with Knee Lifter Rock Shaft, Nos. 143257, 143280-001, 147480, 147482-001, 147483, 147485 and 147491		
Presser Bar Guide Bracket with 50203(830)	149122	Rotating Hook Bobbin Case Holder Position Bracket		
Presser Bar and Feed Roll Lifting Lever with 454(830)	149128-001	Thread Take-up Crank with Thread Take-up Lever with 149160 and eighteen 143056		
Presser Bar Lifting Bracket	149130-002	Thread Take-up Crank and Thread Take-up Lever complete		
Feed Roll Bracket Shaft Oil Retaining Wick 147008 with 146580	149141	Rotating Hook (Air Cooled) with 143301-001 and two 1253(830)		
Arm Shaft (horizontal) Thrust Collar with two 624(830)	149142	Rotating Hook (Air Cooled) 149141 with 143351, 149066 and four 1053(805)		
Combination of Feed and Stitch Regulator Parts, Nos. 143015, 143040, 143049, 143087, 143134, 147472-002 and 147473				
Feed Bar				
Feed Bar 147470 with 21478, 147290, 147355, 147356 and two 1423(803)				
Feed Roll Eccentric				

281-30
Numerical List of Parts for ~~281-30~~ Machine

NUMBER	DESCRIPTION	NUMBER	DESCRIPTION	NUMBER	DESCRIPTION	NUMBER	DESCRIPTION
143124	Stitch Reg. Lever 143085 with 143049 (803), 143066 and 14337b	147025-001	Feed Lifting Rock Shaft	147141	Oil Wick, 11 in. long for oiling Take-up Lever, Take-up Lever Link, Needle Bar Connecting Link and Thread Take-up Lever Link Hinge Bearing(2)		
143191	Presser Bar and Feed Roll Lifting Lever Connecting Rod Oil Mist Retaining Disc (felt)	147028	Feed Lifting Rock Shaft Bushing (front)	147151	Tension Releasing Disc		
143196	Needle Bar Oil Wick	147028	Feed Lifting Rock Shaft Bushing (back)	147152	Tension Spring		
143246	Feed Lifting Rock Shaft Oil Seal Plug Washer (felt)	147029	Feed Lifting Rock Shaft Collar with two 460(830)(2)	147156	Throat Plate (large needle hole) for use with 22634 and 161066		
143256	Feed Roll Shaft Oil Screw Plug Washer (fiber)	147029	Feed Rock Shaft Collar with two 460(830)	147159	Tension Releasing Lever Body		
143240	Arm Top Cover (back) Spool Pin with Spool Rear, 3-1/2 in. long	147030-001	Feed Lifting Rock Shaft 147025-001 with 13996, 147038 and suitable length of No. 1229 White Lighter Wicking	147160	Tension Releasing Lever Body (adjustable) 147159 with 50123(819) and 147161		
143257	Machine Base and Oil Reservoir Gasket (cork)	147037	Feed Lifting Rock Shaft Oil Wick (short)(2)	147161	Tension Releasing Lever Segment		
143260-001	Bed Leg (brake)	147038	Feed Lifting Rock Shaft Oil Wick (long)	147166	Slack Thread Regulator		
143260-001	Knee Lifter Rock Shaft	147040-001	Feed Rock Shaft	147206	Arm Top Cover (front) Gasket		
143282	Knee Lifter Rock Shaft Crank Adjusting Screw 140350(803) with 51649(809)	147041-001	Feed Rock Shaft 147040-001 with 13996, 147046 and suitable length of No. 1229 White Lighter Wicking	147245	Oil Wick Holder with two 147141		
143295	Pair of Gears for Lower Shaft, Nos. 143014 and 143051	147042	Feed Rock Shaft Bushing (back)	147247	Presser Bar Lifter		
143301-001	Rotating Hook Oil Wick (felt)	147043	Feed Rock Shaft Bushing (front)	147250	Presser Bar and Feed Roll Lifting Lever Pin		
143326	Needle Bar Connecting Stud with 140706(803)	147045	Feed Rock Shaft Oil Wick (short)	147290	Feed Lifting Rock Shaft Crank (front) with 140915(830)		
143349-001	Rotating Hook Shaft Oil Filter Wick Holder	147046	Feed Rock Shaft Oil Wick (long)	147291	Presser Bar Spring		
143351	Rotating Hook Wiper (leather)	147050-001	No. 216 B. Connecting Link 147492-002 with 143326	147292	Tension Stud 140873(803) with two 1560(803)		
143370	Oil Lead	147053	Needle Bar Connecting Stud Oil Wick	147293	Tension complete, Nos. 32574, 52083, 52394, 147151, 147152, 147292 and two 2102		
143373	Bell Crank	147055	Oil Removing Wick (head end) Hinge Plate and Cover Gasket	147296	Thread Take-up Lever Oil Guard with 143196 and 147053		
143374	Bell Crank Bushing	147057	Presser Bar (hollow)	147355	Feed Bar Carrier with two each 158(805) and 140788(805)		
143375	Bell Crank Complete, Nos. 143104, 143373 and 143374	147058	Presser Bar Bushing (lower)	147356	Feed Bar Hinge Pin (eccentric)		
143378	Feed Roll Feed Regulator Locking Slide Spring	147070	Thread Take-up Crank Clamping Screw Hole Plug Gasket	147394	Arm Shaft (horizontal) with 1036(830) and 140542(830)		
143378	Stitch Regulator Locking Slide Spring	147073	Thread Take-up Lever Link Hinge Stud	147395	Combination of Feed Roll Feed Parts, Nos. 140733(830) , 143087, 143134, 147472-001, 149042, 149046 and 149203		
143383	Rotating Hook Oil Flow Regulating Throat Screw Spring	147074	Thread Take-up Lever Link Hinge Stud Oil Wick	147396-001	Face Plate		
143384	Oil Pipe for oiling Rotating Hook Shaft (front) Bearing	147075	Thread Take-up Lever Link Hinge Stud 147073 with 147074	147397	Face Plate Gasket		
143387	Oil Pipe 143384 with 143124 for oiling Rotating Hook Shaft Front Bearing	147077	Thread Take-up Lever Guard Gasket	147398-001	Feed Roll (48 teeth) with 447(830)		
146099	Feed Roll Shaft Crank with 140228(830)	147079	Thread Take-up Lever Thread Eyelet Bushing Pressure Regulating Thumb Screw and Presser Bar Guide	147399-001	Note: No. 147398-001 is furnished on order only		
146552	Arm Screw (front end intermediate)(2)	147091	Arm Shaft (upright) Bushing (upper)	147400-001	Feed Roll (32 teeth) with 447(830)		
146580	Feed Roll Bracket Shaft Oil Retaining Wick Clip	147105	Arm Shaft (horizontal) Flanged Bushing (back)	147401-001	Note: No. 147398-002 is furnished on order only		
146560	Feed Roll Clutch Shaft Arm Bushing (front) Oil Wick Clip	147106	Oil Pipe complete from Oil Pump to Arm Shaft (horizontal) Center Bearing, Nos. 143064, 143065 and 143066	147402-001	Feed Roll and Presser Bar Lifting Lever Link		
146591	Oil Flow Body	147107	Oil Removing Wick (head end)	147403-001	Feed Roll Bracket with two 141141(869)		
146610	Presser Bar and Feed Roll Lifting Lever Spring	147108	Oil Removing Wick (head end) Holder Body 146745 with 146698 and 147107	147404-001	Feed Roll Bracket Shaft	147	
146698	Oil Removing Wick (head end) Holder Body Spring	147111-001	Arm Shaft (upright) Bushing (upper)	147405-001	Feed Roll Bracket Shaft Bushing	147	
146745	Oil Removing Wick (head end) Holder Body	147112-001	Arm Shaft (horizontal) Flanged Bushing (back)	147406-001	Feed Roll Bracket Pressure Spring	147	
146790	Arm Shaft (horizontal) Flanged Bushing (back) Oil Sump Tube	147114	Needle Bar Bushing (lower) Thread Eyelet	147407-001	Feed Roll Bracket Pressure Spring Adjusting Nut	147	
147005-001	Arm Shaft (horizontal) Flanged Bushing (front)	147131	Rotating Hook Shaft Oil Retaining Collar with two 50429(830)	147408-001	Feed Roll Bracket Shaft Guide Bracket Holder	147	
147008	Feed Roll Bracket Shaft Oil Retaining Wick	147139	Machine Pulley small rim diameter (disc power) "V" belt groove 2.9 in. diam., with two 51283(830)	147409-001	Feed Roll Clutch (brake)	147	
147011	Arm Top Cover (back) for 147013			147410-001	Feed Roll Clutch (brake) Bushing with two 453(830)	147	
147013	Arm Top Cover (back) with Stitch Regulator Plunger complete, Nos. 13288, 64519, 147011 and 147105			147411-001	Feed Roll Clutch (brake) Member Spring(3)	147	
147015	Arm Top Cover (back) Gasket			147412-001	Feed Roll Clutch (drive)	147	
147017	Feed Bar Carrier Oil Wick Holder with 143031			147413-001			

From the library of: Diamond Needle Corp